

## KRO-CLIP

A versatile clip that allows small roof tile cuts to be mechanically fixed in accordance with BS 5534 Code of Practice for Slating and Tiling at hips, valleys, roof windows and many other applications where it is difficult otherwise to obtain a secure mechanical fixing either at the head or tail of the cut roof tile.

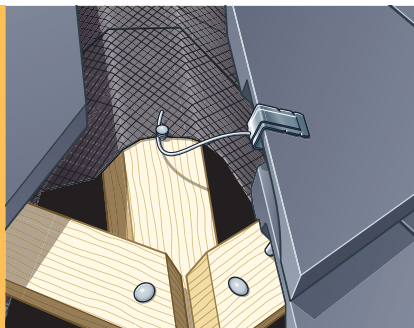

### KRO-CLIP: PRODUCT CODE AND DESCRIPTION

Description	Product Code	Contents	Dimensions	Material
Kro-Clip	9142	50 per box	Wire: 380mm long Clip: 30mm long x 12mm depth (jaw), 16mm depth (back)	Corrosion-resistant stainless spring steel

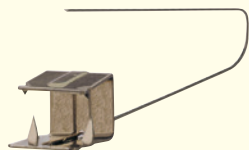

Kro-Clip

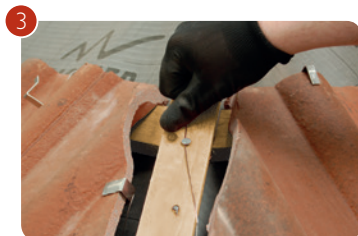
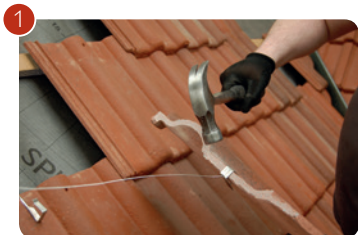

---

**1**

Push the jaws of the Kro-Clip (with the tail pointing towards the back of the tile) onto the edge of the tile and hammer firmly home.

---

**2**

Hammer a nail half way into the rafter (or, as in the picture shown, a hip batten). The fixing point must be located above the clip position, and the distance between the fixing point and the clip must be kept as short as possible.

---

**3**

Wrap the tail several times around the nailed fixing point ensuring that the wire is pulled tight between the fixing point and the clip. Hammer the fixing point nail home to secure the tail.